

MINUTES

Meeting: WESTBURY AREA BOARD
Place: The Laverton Hall, Bratton Road, Westbury, BA13 3EN
Date: 7 December 2017
Start Time: 7.00 pm
Finish Time: 9.30 pm

Please direct any enquiries on these minutes to:

Roger Bishton (Democratic Services Officer), Tel: 01225 713 035 or (e-mail) roger.bishton@wiltshire.gov.uk

Papers available on the Council's website at www.wiltshire.gov.uk

In Attendance:

Wiltshire Councillors

Cllr Russell Hawker (Chairman), Cllr David Jenkins (Vice-Chairman), Cllr Gordon King and Cllr Jerry Wickham

Wiltshire Council Officers

Liam Cripps – Community Engagement Manager
Sara Young – Joint Commissioner – Dementia
Jan Bowra – Locality Youth Facilitator
Roger Bishton – Senior Democratic Services Officer

Town and Parish Councillors

Westbury Town Council – Cllr Ian Cunningham
Edington Parish Council – Cllr Mike Swabey

Partners

Wiltshire Police – Inspector Andy Fee
BA13+ Community Area Partnership – Carole King, Phil McMullan, Michael Walters

Total in attendance: 47

<u>Agenda Item No.</u>	<u>Summary of Issues Discussed and Decision</u>
1.	<p><u>Chairman's Welcome and Introductions</u></p> <p>The Chairman welcomed everyone to the meeting of the Westbury Area Board.</p>
2.	<p><u>Apologies for Absence</u></p> <p>There were no apologies for absence received.</p>
3.	<p><u>Minutes</u></p> <p>Resolved:</p> <p>To confirm and sign the minutes of the meeting held on 12 October 2017.</p> <p><u>Arising therefrom</u></p> <p>Minute No 12 – Provision of Defibrillators in Westbury Dr Peter Biggs referred to the provision of defibrillators in Westbury and suggested that there was a need for at least some basic training for those who might use the equipment. He considered that it would be necessary for two people, if at all possible, to be available to resuscitate, one to administer Cardiopulmonary resuscitation (CPR) whilst the second person used the defibrillator. He also referred to the situation where a person needing resuscitation had requested a Do Not Resuscitate but unless that person carried a card or badge stating this, it would not be likely that this wish were complied with in such a situation.</p>
4.	<p><u>Declarations of Interest</u></p> <p>There were no declarations of interest made at the meeting.</p>
5.	<p><u>Chairman's Announcements</u></p> <p>The Chairman drew attention to the following Announcements, details of which were included in the agenda papers:-</p> <ul style="list-style-type: none"> • Wiltshire Local Plan Review • Eat Out Well Award • Westbury Community Hub – Cllr John Thomson, Cabinet lead for campuses and hubs had stated that the team was currently working on two papers which would be considered by Cabinet in December 2017 and they would be revisiting the hubs and leisure provisions in January 2018.
6.	<p><u>Dementia Services in the Westbury Community Area</u></p>

	<p>A presentation on the current dementia services in the Westbury area and future plans was given by Sara Young, Joint Commissioner – Dementia, Wiltshire Council together with Mark Dickson, Practice Manager, Westbury Health Centre, a copy of which is attached to these minutes at Appendix 1.</p> <p>Sara Young drew attention to the latest report on Dementia, a public consultation on which was completed in August 2017 being the culmination of a two year project. There were now dementia advisors who were linked to GP surgeries in Wiltshire and this would be publicised as part of a public awareness campaign in January 2018. It was important to bring this service to the attention of as many people as possible and, although nobody could be required to make use of this service, it was hoped that a large proportion of those with this disease could be encouraged to seek some help. Although the CCG would be providing some funding for this service there was still much need for further fundraising.</p> <p>The Chairman thanked Sara Young and Mark Dickson for attending this meeting and making their presentation which those present had found most interesting and useful.</p>
7.	<p><u>Partner and Community Updates</u></p> <p>The Area Board received and noted the following updates from key partners:-</p> <p>(a) Wiltshire Police Inspector Andy Fee presented his report from which it was noted that the number of reported crime incidents during October had slightly fallen compared with figures for the same month in 2016. He stated that a detailed breakdown of crime in the area was available at https://www.police.uk/wiltshire/</p> <p>(b) Dorset and Wiltshire Fire & Rescue Service The written report was received and noted.</p> <p>(c) Westbury LYN Jan Bowra, Locality Youth Facilitator, tabled a short progress report which was noted. (Appendix 2 to these minutes)</p> <p>(d) BA13+ Community Area Partnership Carole King presented a written report which had been circulated with the agenda papers. She drew attention to Dementia Action Alliance questionnaires which she had tabled and encouraged those present to complete and return to dementiaactionalliance@alzheimers.org.uk .</p> <p>(e) Wiltshire Clinical Commissioning Group The written report was received and noted.</p> <p>(f) Healthwatch Wiltshire The written report was received and noted.</p> <p>(g) Westbury Town Council Cllr Ian Cunningham presented a written</p>

	<p>report which had been circulated with the agenda papers. He informed those present that the Town Council's Finance Committee would be setting the precept for 2018/19 at its meeting on 11 December 2017.</p>
<p>8.</p>	<p><u>Tarmac Planning Application for a new precast concrete manufacturing unit at former Cement Works, Westbury</u></p> <p>The Chairman introduced and welcomed Jonathan Toyn, Peter Heubeck and Danny Daniels from Tarmac Building Products Ltd who were attending to make a presentation on their proposals to develop a new precast concrete manufacturing unit at the former Cement Works, Westbury, a copy of which is attached to these minutes at Appendix 3.</p> <p>During discussion, some concern was expressed at the number of lorry movements that would be required and also the route that would be taken to and from the site. The developer explained that two different routes were being proposed, one of which would avoid Westbury and ongoing discussions would take place with the appropriate councils and the wider community concerning this. The meeting was informed that although rail would be used as far as possible, the Company's main supply of materials would come from its quarry at Halecombe, Mendip, from where there was unfortunately no rail service. It was estimated that there would be about 21 to 23 lorry movements during a 24 hour period on weekdays.</p> <p>Regarding noise pollution, the developer was confident that even the closest residents in Coach Road would not be affected, the site being large.</p> <p>The Chairman thanked the representatives from Tarmac Building Products Ltd for their presentation which was much appreciated.</p>
<p>9.</p>	<p><u>Northacre Renewable Energy Ltd's proposal to submit a Section 73 application to update the layout of the advanced thermal treatment facility following a review of the original proposals at Northacre Industrial Park, Westbury</u></p> <p>The Chairman introduced and welcomed Ed Dodd from Hills Waste Solutions and Alex Young from the Bioenergy Infrastructure Group who were attending to explain Northacre Renewable Energy Ltd's proposal to submit a Section 73 application to amend the existing full planning permission for an Advanced Thermal Treatment Facility at Northacre Industrial Park, Westbury. A copy of the presentation is attached to these minutes at Appendix 4.</p> <p>During discussion, concern was expressed at the perceived increase in pollution that this change would create. It was pointed out that the stack would be increased from 60 metres to 75 metres in height as a result of Directives. With regard to noise, there would be no change from current levels and the number of lorry movements would be between seven and ten lorry movements per day and these would be conditioned if planning permission were granted.</p>

	<p>The developers stressed that, separate from the planning process, the Environment Agency were required to consider the proposals and issue a very detailed Environmental Permit before work could commence on site. The Environment Agency would be carrying out a separate consultation exercise in the New Year.</p> <p>The Chairman thanked Ed Dodd and Alex Young for their presentation which was much appreciated.</p>
10.	<p><u>Community Area Grants</u></p> <p>Consideration was given to a report by the Community Engagement Manager in which councillors were asked to consider funding from the 2017/18 Area Grants Budget, all of which met the grants criteria. After receiving brief statements from the applicants giving reasons for the requests,</p> <p>Resolved:</p> <ol style="list-style-type: none"> (1) Application 2620 – Leigh Park Community Centre To approve a grant of £998.50 towards the provision of affordable community events and open day, on the condition that the grant is charged to the Health & Wellbeing Budget. (2) Application 2622 – Bratton Jubilee Hall Management Committee To approve a grant of £3558.13 towards the replacement of the air conditioning unit. (3) Application 2569 – Edington Parish Council To approve a grant of £862.00 towards the cost of providing a new video projector for use in the village. (4) Application 2551 – Ethandun Tapestry Project Group To approve a grant of £250.00 towards the Ethandun Tapestry Project. (5) Application 2609 – Dilton Memorial Hall Trustees To approve a grant of £2000.00 towards the Dilton Marsh Memorial Hall storage and utilities modernisation.
11.	<p><u>Westbury Community Area Transport Group</u></p> <p>The Area Board received notes of the Westbury Community Area Transport</p>

	<p>Group (CATG) meeting held on 17 November 2017.</p> <p>Resolved:</p> <p>(1) To endorse the Area Board's previous decision to contribute £5,000.00 towards the provision of a new footway near The Ham Cottages to serve a relocated bus stop.</p> <p>(2) To allocate £2,250.00 towards the cost of providing improved disabled access on The Mead to allow access to the footpath near the Lakes.</p>
12.	<p><u>Appointments to Outside Bodies</u></p> <p>At its meeting on 15 June 2017, this Area Board appointed Cllr Russell Hawker to membership of the Leigh Park Community Centre (Westbury). This appointment had been made for several years on a temporary basis until such time as the completion of the Lease with Wiltshire Council. It was reported that this had now been completed as a result of which there was no need for a representative of Wiltshire Council to be a member of this body. Accordingly Cllr Hawker had resigned his position.</p>
13.	<p><u>Urgent items</u></p> <p>There were no urgent items of business.</p>
14.	<p><u>Future Meeting Dates</u></p> <p>The next meeting of the Westbury Area Board will be held on Thursday 1 February 2018 at The Laverton, Westbury.</p>

Dementia Services in the Westbury Community Area

- Presentation by CCG member, Dr Muhammed Rehman from Westbury Health Centre, together with the Practice Manager and Sara Young, Joint Commissioner - Dementia

Dementia Update Westbury

Sara Young – Joint Commissioner Dementia

Mark Dickson - Practice Manager
Westbury Group Practice

7th December 2017

Wiltshire Dementia Strategy

- Wiltshire Dementia Delivery Board
- Board stakeholders include; Acute Trusts, Hospice, Healthwatch, 3rd Sector Organisations, Carer representative, Wiltshire CCG, Wiltshire Council.
- Meet Bi monthly
- Ensure the Dementia Strategy is being delivered

Involvement of people with dementia

- Healthwatch
- 5 reports produced associated with dementia in 3 yrs
- Most recent public consultation completed Aug 2017
- Report to be published
- Joint Commissioner to produce 'You said, we did' report by end 1st ¼ 2018

Wiltshire Dementia Aware Project

- Over 4500 Dementia Friends across Wiltshire
- Area Boards now taken steps to become Dementia Action Alliances
- All Leisure Centre, Library Staff Dementia Friends
- Schools across the County involved.
- Work still ongoing re awareness and Dementia Friends Sessions

Support for area boards and their communities to become DAAs

- The Westbury DAA was registered in June/July
- Steering group
- Action plan
- Wide representation from across the community including people with dementia and carers

Dementia Diagnosis

A timely diagnosis can enable people to receive the correct treatment, make decisions about their future and receive appropriate financial benefits. It can also help in research looking for better treatments for Dementia in the future as well as help to ensure there are sufficient services for people with Dementia in all community areas across Wiltshire.

Wiltshire Dementia Diagnosis Rate (DDR)

- National Target is 66.7%
- Current Wiltshire DDR 65.8% (Oct 2017)
- Local Enhanced Service
- GP Training (Jan 2018)
- Dementia Adviser Service
- Public Awareness Campaign Jan 2018

Westbury Group Practice

- WGP Dementia Strategy – has been written by Aimee. A new nurse has been employed by the practice and is starting in January as our lead dementia nurse. She will be implementing this strategy.
- WGP Dementia Pathway – is an appendix to our strategy document.
- WGP Dementia Friendly Action Plan – is also part of strategy. The practice is aiming to become dementia friendly this document shows what we have achieved, is in progress and still to do.

Westbury Group Practice

- Westbury PCO Scheme –Dementia - We plan to implement the WGP dementia strategy as a PCO locality project.
- Dementia Diagnosis Service Spec – this is the enhanced service we are currently signed up to deliver. The aim of this is to diagnose and treat if appropriate in primary care.



Dementia Advisor Contract

- 2yr Contract until April 2019 – Alzheimer's Support
- Linked to GP Practices
- Information, Support, Signposting, Facilitator to community services.
- Support the Practice Staff

Dementia Community Services

Delivered by Alzheimer's Support

- Memory Cafe
- Music for the Mind
- Movement for the Mind
- Carers Support & Training
- Day Clubs
- Art Groups
- Home Care & Support Service

Links for more information

- www.dementiafriends.org.uk
- www.dementiaaction.org.uk
- https://www.dementiaaction.org.uk/south_west/24257_westbury_community_area_dementia_action_alliance
- sara.young@wiltshire.gov.uk
- www.yourcareyoursupportwiltshire.org.uk
- www.alzheimerswiltshire.org.uk

This page is intentionally left blank

Report to	Westbury Area Board
Date of meeting	7 th December 2017
Title of report	Youth Grant Funding

1. Financial update

- 1.1. For 2017/18 Westbury Area Board was allocated £14,318.00
- 1.2. The Westbury Area Board Youth Funding balance for 2017/18 is £4266.50
- 1.3. All decisions must fall within the Youth Funding allocated to Westbury Area Board.

2. LYN report

A Local Youth Network meeting was held on the 7th November 2017 where no grant applications were submitted due to the no further funds available. Notes from meeting attached.

No unpublished documents have been relied upon in the preparation of this report

Report Author	Name, Jan Bowra Locality Youth Facilitator Email: janette.bowra@wiltshire.gov.uk
----------------------	---

This page is intentionally left blank

Westbury Area Board 7th December

Tarmac Application for Outline Planning Permission

We Are:-

Jonathan Toyn - Tarmac Property

Peter Heubeck - Project Manager

Danny Daniels - Community Liaison



Our Application

Submitted on 27th October

For Outline Planning Permission

To establish principle of development

Assessments based on maximum building sizes & approximate positions

May be smaller

Wiltshire requested consultation responses by 8th December

The Consultation Process

Wiltshire Council publicise application and place all documents on website

This includes consultation responses

We contacted our immediate neighbours on Coach Road

Attended Heywood Parish Council meeting on 13th November

Attended Westbury Highways, Planning & Development

Committee on 20th November



Our Product

Concrete slab track
Slabs up to 6 metres long
2.55 metres wide
Weigh up to 9 tonnes
For use on high speed lines



Slab Track Manufacturing

Concrete batching plant
One/two manufacturing buildings
Finishing building
Laboratory
Staff welfare facilities
Outdoor storage of manufactured slabs
Despatched by rail



Manufacturing

A clean process

Very precise high tech manufacturing

Tolerances of less than 1 millimetre!

Three-shift operations on weekdays

Machine maintenance and production catch-up at weekends



Employment

Around 85 additional staff

Production

Stockyard

Laboratory technicians

Fitters & electricians

Planning & commercial

No impact on existing activities



Technical Assessments

Planning policy
Transport
Visual impact
Heritage
Air quality
Flood risk
Ecology



Assessment Conclusions

No planning policy objections

Lorries from Halecombe quarry can avoid Westbury

**Good design can improve appearance of site when viewed from
White Horse & Bratton Camp**

**No air quality problems (dust control measures during
construction)**

No history of Heywood Brook flooding the site

Sensitive species already safeguarded prior to demolition

Next Steps

Wiltshire Council to consider responses & decide on application
If successful, we bid for manufacturing contracts
Undertake detailed design
Submit application for detailed planning consent
If successful, construct & commission factory



Any Questions?













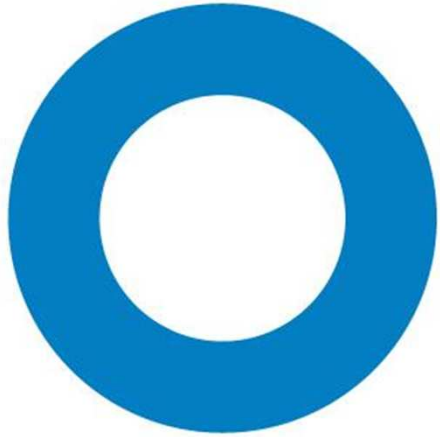

TARMAC
A CRH COMPANY



EfW Progress Update

Northacre Renewable Energy Ltd



Page 41



Minute Item 9.

Status

- 2015 - Planning permission granted
- Interim period - working on Contract for Difference process and negotiations with the Engineering, Procurement and Construction contractor
- 2017 - Project awarded 15 year Contract For Difference (government subsidy for renewable energy projects)

CFD ROUND 2 SUCCESSFUL PROJECTS

Strike prices, capacities, technologies and connection sites for the 11 Successful Projects below:

(CFD Round 2 was run across two Delivery Years – 2021/22 and 2022/23, but did not include Solar or Onshore Wind)

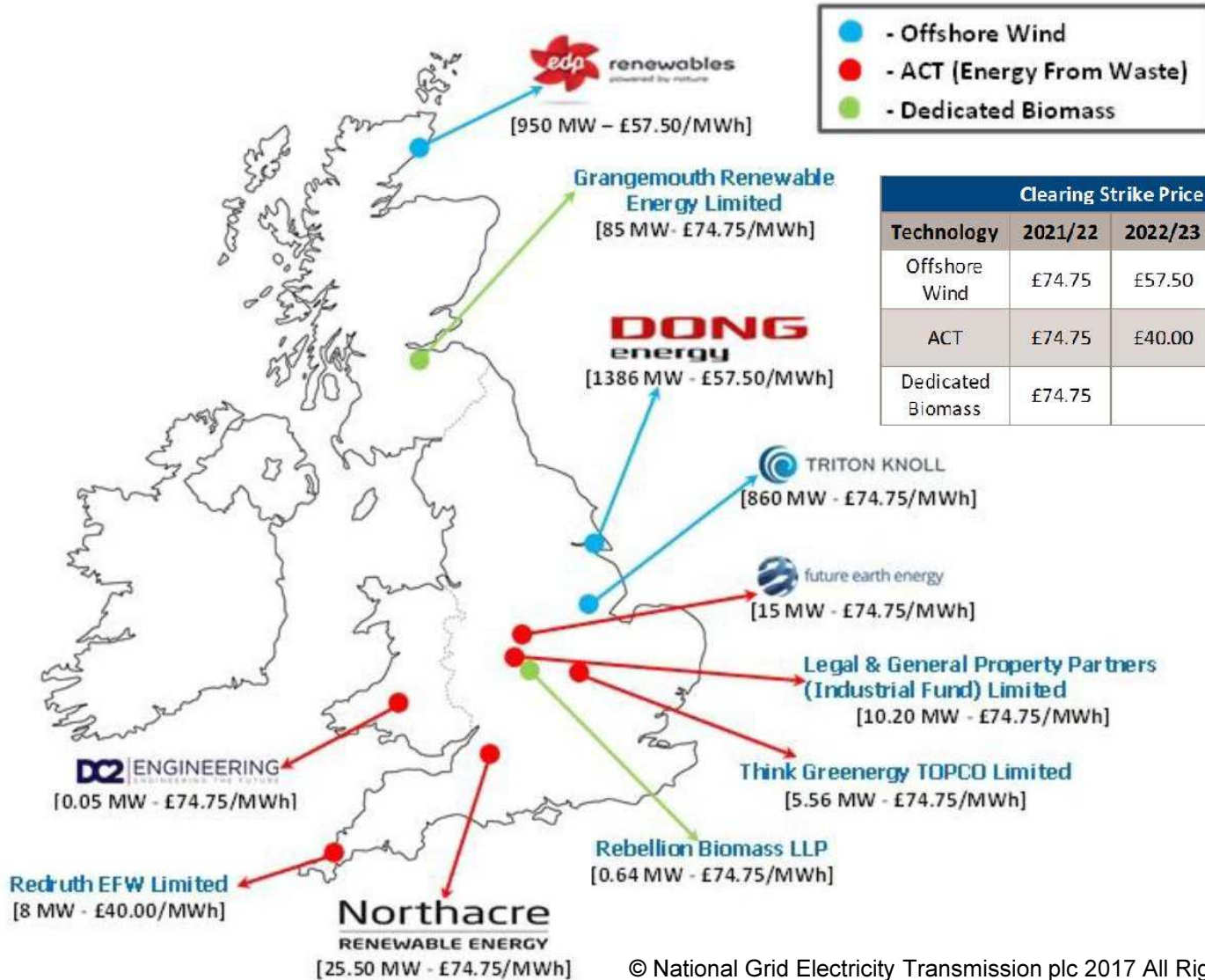

© National Grid Electricity Transmission plc 2017 All Rights Reserved

Engineering Procurement & Construction

Engineering Procurement and Construction contract supplies a turnkey solution for the design, procurement and construction of the project plant including :

- Civils and structures
- Mechanical / electrical and instrumentation
- Turbine
- Air cooled condensers
- Gasifier
- Stack and associated Air Pollution Control equipment

Section 73 planning application

The Section 73 planning application is a result of:

- Negotiations with the Engineering Procurement and Construction contractor
- Assessments of emerging guidance from the Environment Agency on Best Available Technique (BAT)

Section 73 applications for variations to a project on this scale are part of the process and there are likely to be others. The planning system allows for it.

Section 73 application covers

- Increase in height of buildings
- Increase in stack height
- Enclosing the thermal plant
- Separating the waste reception building and the thermal building
- One less turbine and bank of air cooled condensers

Original Layout

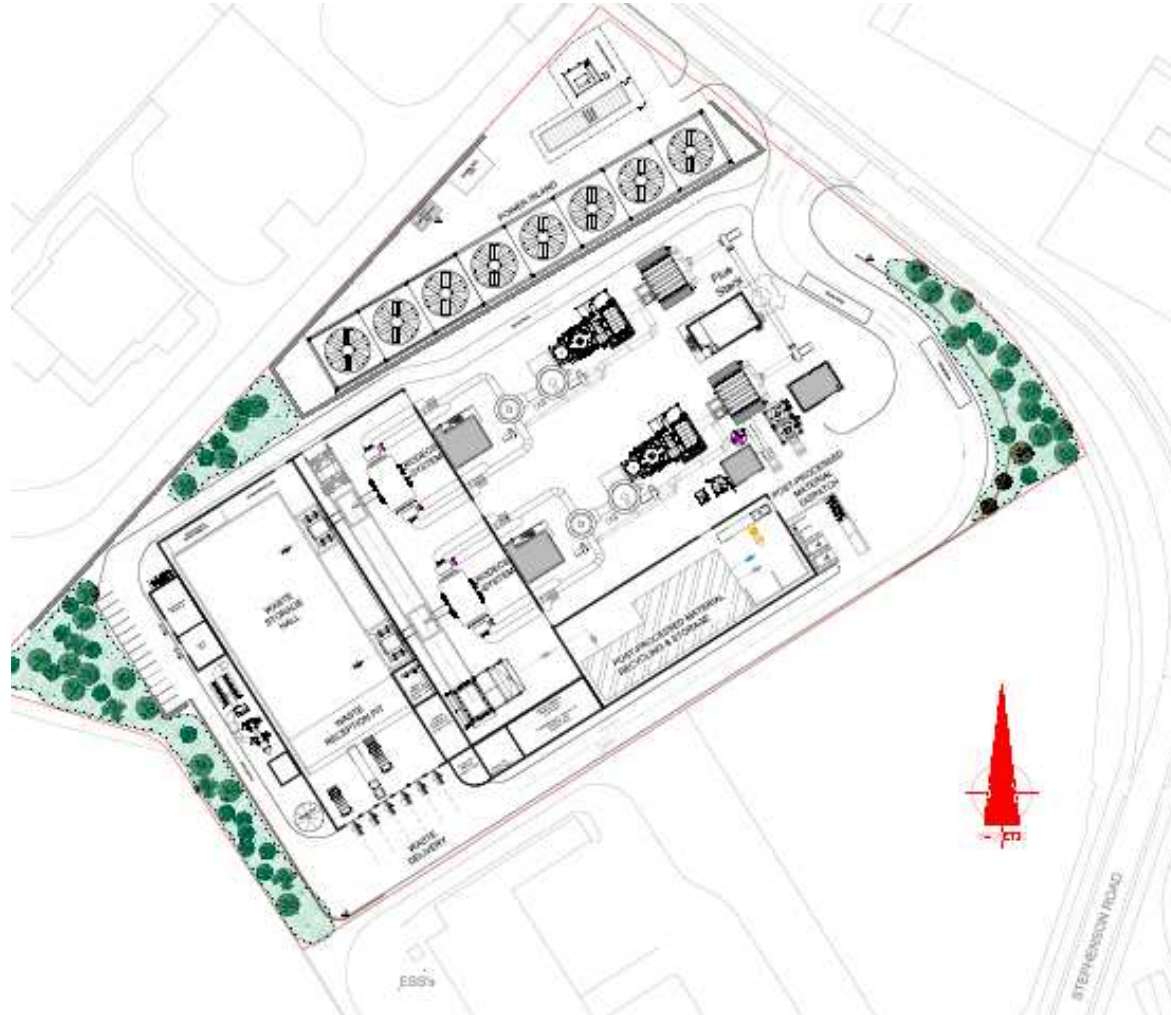

Revised Layout



Environmental Permit process

- An Environmental Permit is required in order to have permission operate the plant
- The Environment Agency will assess the Environmental Permit application against Best Available Techniques (BAT)
- The Environment Agency will regulate the facility and emissions against the Environmental Permit

Project Timetable

- Final negotiations - EPC Contractor and Grid Connection route proving
- Financial Close – Quarter 2 / 2018
- Environmental Permit application – Quarter 2 / 2018
- Est. 34 month construction – summer/autumn 2018 (150+jobs)
- Project ‘energised’ – April 2020
- Start commercial operations – April 2021 (35-40 permanent full time jobs)